





Park@Sol Pro Carport System

We thank you for your interest in our carport systems. Please enter all information requested in the form below to allow us to generate an offer tailored to your specific requirements. Please note: The fields marked with → are mandatory fields!



<p>Project data</p> <p>Project name _____</p> <p>Number of carports Total power (kWp) _____</p>	<p>Company data</p> <p>→ _____ Customer number</p> <p>→ _____ Company name</p> <p>If you are a new customer, please enter your company name and contact details:</p> <p>Company _____</p> <p>Street _____</p> <p>Postal code Town / City _____</p> <p>Country _____</p> <p>VAT/Tax ID _____</p>	<p>Contact person</p> <p>_____</p> <p>First name _____</p> <p>_____</p> <p>Last name _____</p> <p>_____</p> <p>Telephone _____</p> <p>_____</p> <p>Mobile _____</p> <p>_____</p> <p>Fax _____</p> <p>_____</p> <p>Email _____</p>
---	--	--

Terrain category

				
<input type="radio"/> Terrain category 0 Sea, coastal area exposed to open sea	<input type="radio"/> Terrain category I Lakes or area with negligible vegetation and without obstacles	<input type="radio"/> Terrain category II Area with low vegetation such as grass and isolated obstacles (trees, buildings) with separations of at least 20 obstacle heights	<input type="radio"/> Terrain category III Area with regular cover of vegetation or buildings or with isolated obstacles with separations of max. 20 obstacle heights (such as villages, suburban terrain, permanent forest)	<input type="radio"/> Terrain category IV Area in which at least 15% of the surface is covered with buildings and whose average height exceeds 15 m

<p>Geographical data</p> <p>→ _____ Postal code Town/City</p> <p>_____</p> <p>Country _____</p> <p>→ _____ Height above sea level (m)</p> <p>Terrain specifications</p> <p><input type="radio"/> Inclined _____ °</p> <p><input type="radio"/> Flat</p>	<p>Modules</p> <p>_____</p> <p>Module name _____</p> <p>→ _____</p> <p>Module power (Wp) _____</p> <p>→ → →</p> <p>Length (mm) Width (mm) Thickness (mm)</p> <p>_____</p> <p>Number of modules arranged one above the other _____</p> <p>_____</p> <p>Number of modules arranged next to each other _____</p>	<p>Module arrangement</p> <p><input type="radio"/> In portrait</p> <p><input type="radio"/> In landscape</p> <p><i>Park@Sol Pro is only suitable for framed modules!</i></p>
--	--	---

Thank you for taking the time to provide us with all required information.

We have a number of basic designs available so you can select the optimal and most economic solution for the space at your disposal. Each plant is individually configured to the customer's requirements and to the requested basic design, taking the following parameters into account:

- Module type and design
- Plant size
- Soil conditions
- Distances between supports / apportioning of the parking area

Please note: Depending on the design, the risk of snow masses sliding off the roof must be considered in the planning. Accessory components for minimizing the impact of snow slide are available on request; however, depending on the module orientation, please also consider the possibility of module shading when planning the installation of such anti-slide components.

Design

S1 1-rowed vehicle arrangement

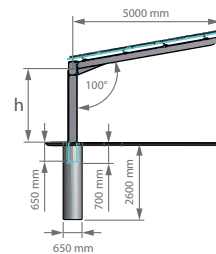

S2 2-rowed vehicle arrangement

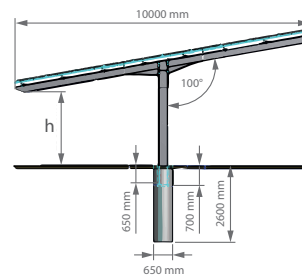

S3 2-rowed vehicle arrangement

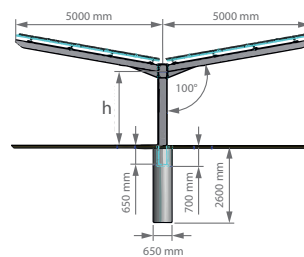

Clearance height h (see dimension drawing)

- Design 2200, $h = 1959$ mm
- Design 2500, $h = 2259$ mm
- Design 2800, $h = 2559$ mm

Contact

Name of contact person to provide the on-site briefing:

Name of contact who provides the on-site briefing

Telephone

Directions to site / localization

Address (if registered):

Site plan (for Windows live search, Google-Maps, Google-Earth, etc.)

Corner coordinate of the site

geographical (degrees° min.' sec.“)

or UTM:

Current activities to shift earth

Earth movements have been carried out on the site.

Earth movements are currently being carried out on the site.

Earth movements are planned to be carried out on the site.

Supply lines

Are there any supply lines on the site? Please check all relevant boxes and, if possible, send us related plans with dimensions:

Electricity

Water

Gas

Telephone

Drainage

There are no supply lines

Data relating to the surface

Plaster

Concrete

Asphalt

Soil properties

Does the subsoil consist completely or partly of:

Backfilled earth

Hazardous waste / contaminated site

Are measures being taken / have measures been taken to improve the quality of ground (soil excavation, geogrid / fleece)?

Further information on the site

Explosive ordnance and explosive ordnance residues

We act on the assumption that no explosive ordnance is present beneath the surface. In the case of industrial land and redundant airport terrain in particular, we recommend querying an aerial photo database (e.g. www.luftbilddatenbank.de) and would ask you to provide us with an accordant written confirmation when placing an order.

The following points must be taken into account when conducting the survey:

- When beginning the ground survey, our lead surveyor is to be briefed by a representative of your company regarding the terrain to be inspected. The brief should take place on-site and using a site plan. By following this procedure, the inspection of irrelevant terrain and/or damage to supply lines can be avoided.
- In so far as a geotechnical report is already available or there are known particularities relating to the area to be tested, these must be communicated to us prior to the start of operation.
- The results of the survey aid in evaluating the building ground.
- A further survey may be necessary following ensuing changes made to the construction ground (e.g. earthwork, backfilling, ground-shift etc.). This can, however, result in additional costs which must be borne by the customer.
- The examination can be carried out only once the checklist has been completed and returned to us together with the site plan.
- The General Terms and Conditions of Sale and Supply and the current versions of the Schletter GmbH General Terms and Conditions for Installation apply. These terms and conditions can be referenced at any time on the internet at http://www.schletter-group.com/AGB_en.

I hereby confirm that the information provided in the site plans and in the trial pile-driving checklist is correct and up to date. I acknowledge that any changes made to the building ground may result in a requirement for additional ground surveys for which the customer will have to pay.

Town

Date

Signature

Thank you for taking your time to provide us with all required information.

Once we have received your completed checklist we will draw up your calculation as quickly as possible. Please return the checklist by fax to +49 8072 9191-9200 or by email to anfrage@schletter-group.com!

Further information at: www.schletter-group.com.



SCHLETTER GMBH
Gewerbegebiet an der B15
Alustrasse 1
D- 83527 Kirchdorf/Haag i.OB
GERMANY

SCHLETTER (Shanghai)
Solar Technology Co., Ltd
677 Beihe Gong Road
Jiading, Shanghai
201807 PR CHINA

SCHLETTER Inc.
1001 Commerce Center Drive
Shelby, North Carolina 28150
USA

www.schletter-group.com